

mimatic®

Tool Systems

Your Partner For Clever Tooling

Cutting Tools

- Thread milling
- Groove milling
- Gear milling
- Contour and radius milling
- Dovetail milling
- Sawing, cutting, slitting
- etc.

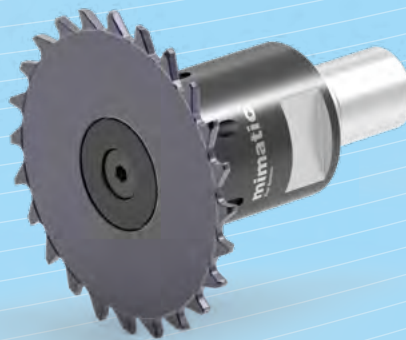
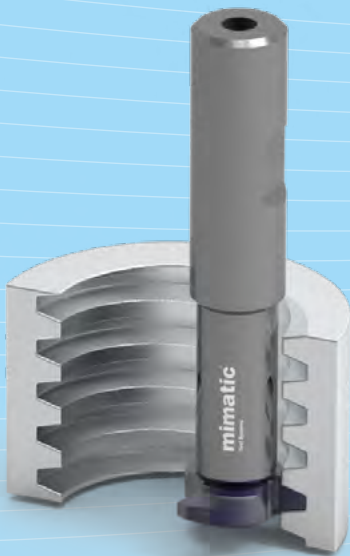

Manufacturer of Precision Tools Since 1974

Slot Milling

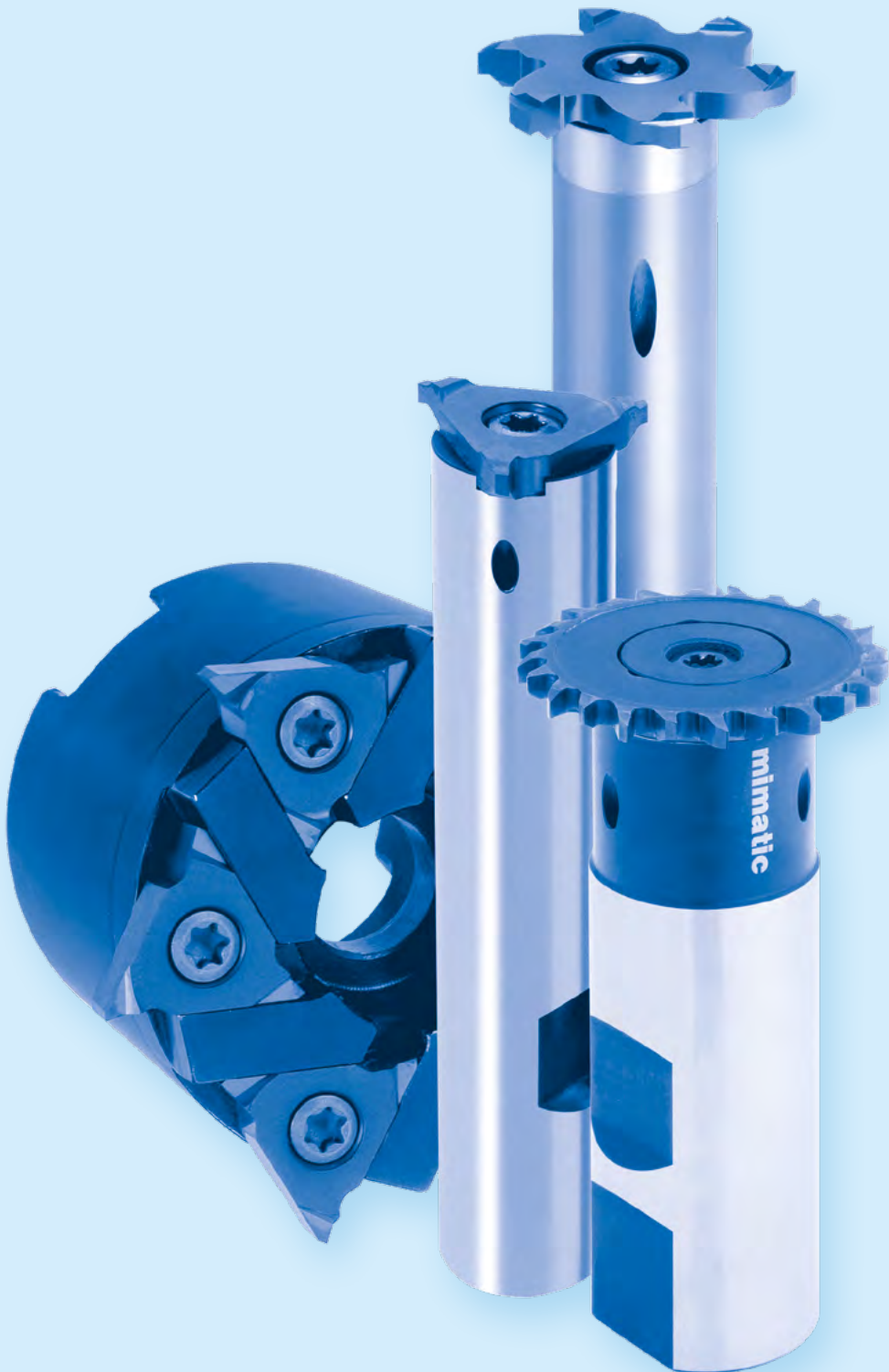

Table of Contents

PolyMILL



Inserts	
Slot Milling	86-88
Circlip grooves	88-89
Toolholders	
with cylindrical shank	90
for driven toolholders	91
with tightening shank	92

TriMILL



Inserts	
Slot Milling	93+96
Circlip grooves	93-97
O-Ring grooves	94+97
Face milling with drag chamfer	97
Toolholders	
with cylindrical shank	95+98
with tightening shank	95+98
Face milling cutter	98-99

DeepMILL



Toolholders and Discs	
Ø 32 mm	102
Ø 40 mm	103
Ø 50 mm	104
Ø 63 mm	105
Ø 80 mm	106
Special Toolholders	
with locating bore	107
Sawblade arbor	108
Assembling instruction	
Cutting data	168

Keyway Slot Milling Cutter











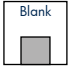







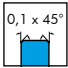
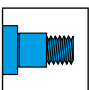
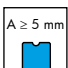
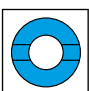

Keyway Slot Milling Cutter	109
----------------------------	-----

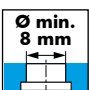
Technical Data

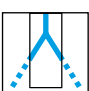
Tips about circular and thread milling	176
Cutting data	166-169
Carbide grades	179

Symbols

	Type designation		Blank inserts must be equipped with a clearance angle!
	Tool shank without clamping surface		Inserts without profile, ready for use with clearance angle.
	Tool shank with Weldon clamping surface		Inserts for guard ring slots
	Solid carbide shaft without clamping surface		Inserts for O-ring slots
	Solid carbide shaft with Weldon clamping surface		DIN standard
	Tool with Conical tool shank		Inserts with chamfered edges
	Tool with tightening thread		Inserts with chipbreakers from 5 mm cutting width
	Cutter with cross groove		For chamfering and deburring
	Smallest necessary bore-diameter		Number of inserts (Polygon Cutter)
	Maximum cutting depth		Number of inserts (Polygon Cutter)
	Internal coolant supply		Thread depth max.
			Edge radius
			Full radius
			Milling inserts for cutting off

5

Formula for Tool Lengths

$$L_{WKZ} = L_{GK} + L_1 + L_{P1} (+L_{P2})$$

PolyMILL

Slot Milling

- Insert holder see page 90-92
- Cutting data see page 166

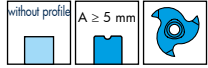
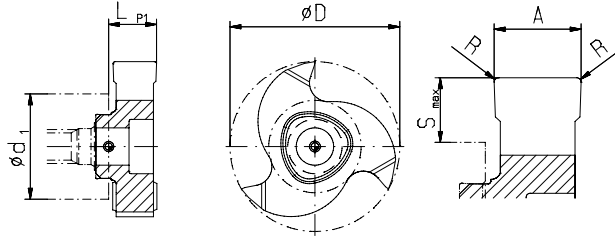

Type	A mm	A inch	D mm	Rake Angle	R mm	LP1 mm	LP2 mm	S _{max} mm	Number of teeth	Order No. TINAMATIC	
P12	P1210	0,74	.029	9,6	6°	0,1	3,25	0,1	1,2	3	171915
	P1210	0,84	.033	9,6	6°	0,1	3,25	0,1	1,2	3	171916
	P1210	1	.039	9,6	6°	0,1	3,25	0,1	1,2	3	171917
	P1210	1,2	.047	9,6	6°	0,1	3,25	0,1	1,2	3	171918
	P1210	1,4	.055	9,6	6°	0,1	3,25	0,1	1,2	3	171919
	P1210	1,5	.059	9,6	6°	0,1	3,25	0,1	1,2	3	171920
	P1210	1,575	.062	9,6	6°	0,1	3,25	0,1	1,2	3	173937
	P1210	1,7	.067	9,6	6°	0,1	3,25	0,1	1,2	3	171921
	P1210	2	.079	9,6	6°	0,1	3,75	-	1,2	3	171922
	P1210	2,5	.098	9,6	6°	0,1	3,75	-	1,2	3	171923
	P1212	1,5	.059	11,7	6°	0,1	3,4	-	2,25	3	171862
	P1212	2	.079	11,7	6°	0,15	3,4	-	2,25	3	171863
	P1212	2,5	.098	11,7	6°	0,15	3,4	-	2,25	3	171865
	P1212	3	.118	11,7	6°	0,15	3,55	-	2,25	3	171866
P1212	3,175	.125	11,7	6°	0,15	3,75	-	2,25	3	173938	
P16	P1616	3,5	.138	16	0°	0,15	4,15	-	3,5	3	142531
	P1616	3,5	.138	16	8°	0,15	4,15	-	3,5	3	142486
	P1616	3,5	.138	16	12°	0,15	4,15	-	3,5	3	142526
	P1616	5	.197	16	0°	0,15	5,65	-	3,5	3	142511
	P1616	5	.197	16	8°	0,15	5,65	-	3,5	3	142541
	P1616	5	.197	16	12°	0,15	5,65	-	3,5	3	142457
P25	P2525	4	.157	25	0°	0,15	4,65	-	5,7	3	142556
	P2525	4	.157	25	8°	0,15	4,65	-	5,7	3	142546
	P2525	4	.157	25	12°	0,15	4,65	-	5,7	3	142579
	P2525	5	.197	25	8°	0,15	5,75	-	5,7	3	142538
	P2525	6	.236	25	8°	0,15	6,90	-	5,7	3	160907
	P2525	6,35	.250	25	8°	0,15	7,15	-	5,7	3	173939
	P2525	6,5	.256	25	0°	0,15	7,15	-	5,7	3	142582
	P2525	6,5	.256	25	8°	0,15	7,15	-	5,7	3	142610
	P2525	6,5	.256	25	12°	0,15	7,15	-	5,7	3	142574
	P2525	8	.315	25	0°	0,15	8,65	-	5,7	3	142558
	P2525	8	.315	25	8°	0,15	8,65	-	5,7	3	142578
P2525	8	.315	25	12°	0,15	8,65	-	5,7	3	142588	

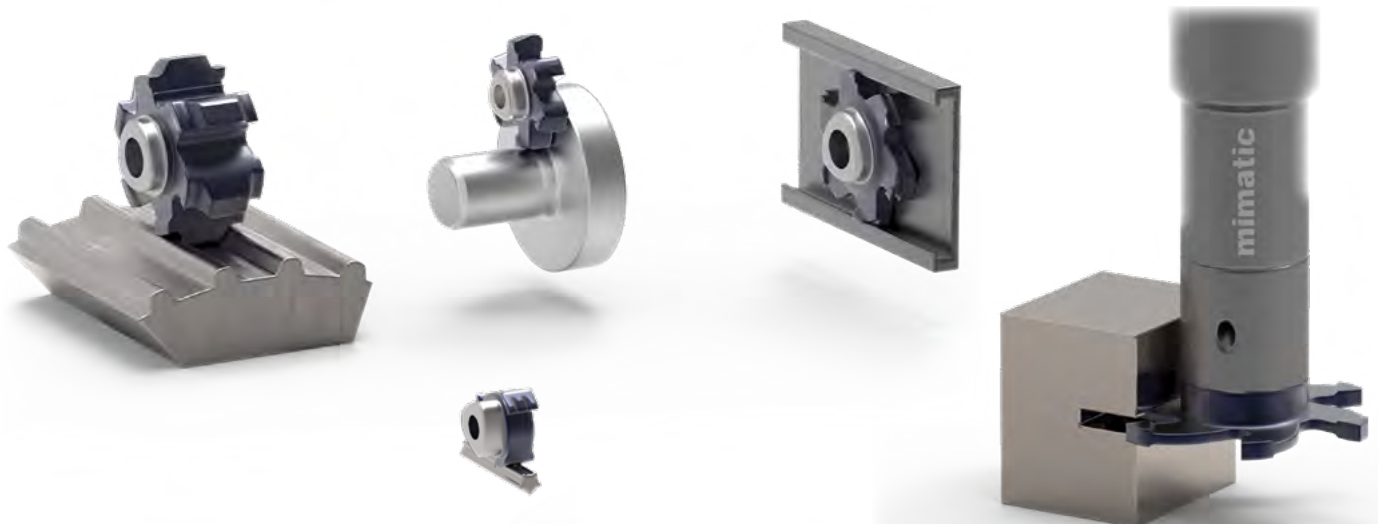

PolyMILL

Slot Milling, Straight Toothed

- Insert holder see page 90-92
- Cutting data see page 166

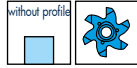
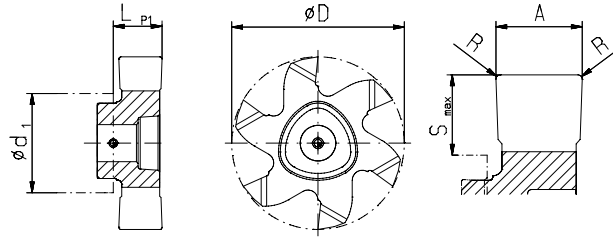

Type	A mm	A inch	D mm	Rake Angle	R mm	LP1 mm	S max. mm	Number of teeth	Order No. TINAMATIC	
P16	P1616	3,0	.118	16,0	6°	0,15	3,53	3,5	6	142494
	P1616	3,175	.125	16,0	6°	0,10	3,74	3,5	6	173929
	P1616	4,0	.157	16,0	6°	0,15	4,65	3,5	6	142565
	P1616	5,0	.197	16,0	6°	0,15	5,65	3,5	6	142586
	P1618	1,2	.047	17,7	6°	0,1	4,0	4,0	6	171937
	P1618	1,4	.055	17,7	6°	0,1	4,0	4,0	6	171938
	P1618	1,5	.059	17,7	6°	0,1	3,9	4,0	6	171939
	P1618	1,57	.062	17,7	6°	0,1	3,9	4,0	6	173928
	P1618	1,7	.067	17,7	6°	0,1	4,0	4,0	6	171940
	P1618	2,0	.079	17,7	6°	0,1	3,9	4,0	6	171941
	P1618	2,39	.094	17,7	6°	0,15	4,0	4,0	6	171942
	P1618	2,5	.098	17,7	6°	0,15	3,9	4,0	6	171943
P20	P2020	3,0	.118	20,0	6°	0,15	3,65	4,2	6	168673
	P2020	4,0	.157	20,0	6°	0,15	4,65	4,2	6	168674
	P2020	5,0	.197	20,0	6°	0,15	5,65	4,2	6	142655
	P2022	1,4	.055	21,7	6°	0,1	5,0	5,0	6	171956
	P2022	1,5	.059	21,7	6°	0,1	5,0	5,0	6	171957
	P2022	1,57	.062	21,7	6°	0,1	5,0	5,0	6	173930
	P2022	1,7	.067	21,7	6°	0,1	5,0	5,0	6	171958
	P2022	2,0	.079	21,7	6°	0,1	5,0	5,0	6	171959
	P2022	2,39	.094	21,7	6°	0,15	5,0	5,0	6	171960
	P2022	2,5	.098	21,7	6°	0,15	5,0	5,0	6	171961
	P2022	3,0	.118	21,7	6°	0,15	5,0	5,0	6	171962
	P2022	3,175	.125	21,7	6°	0,15	5,0	5,0	6	171963
	P2022	4,0	.157	21,7	6°	0,15	5,0	5,0	6	182370
	P2022	5,0	.197	21,7	6°	0,15	6,0	5,0	6	187947
P25	P2526	3,0	.118	26,0	6°	0,15	3,65	6,2	6	142601
	P2526	3,175	.125	26,0	6°	0,15	3,7	6,2	6	173932
	P2526	4,0	.157	26,0	6°	0,15	4,65	6,2	6	142677
	P2526	5,0	.197	26,0	6°	0,15	6,9	6,2	6	142589
	P2526	6,0	.236	26,0	6°	0,15	7,15	6,2	6	162646
	P2526	6,35	.250	26,0	6°	0,15	6,95	6,2	6	173931
	P2526	6,5	.256	26,0	6°	0,15	7,15	6,2	6	142618
	P2528	1,5	.059	27,7	6°	0,1	4,9	6,8	6	171981
	P2528	2,0	.079	27,7	6°	0,1	4,9	6,8	6	171982
	P2528	2,39	.094	27,7	6°	0,15	4,9	6,8	6	171983
	P2528	2,5	.098	27,7	6°	0,15	4,9	6,8	6	171984
	P2528	3,0	.118	27,7	6°	0,15	4,9	6,8	6	171985
	P2528	3,175	.125	27,7	6°	0,15	5,0	6,8	6	171986
	P2537	1,0	.039	37,0	6°	0,15	4,9	11,5	6	195886 NEW
	P2537	1,5	.059	37,0	6°	0,15	4,9	11,5	6	195900 NEW
	P2537	2,0	.079	37,0	6°	0,15	4,9	11,5	6	195903 NEW
	P2537	2,5	.098	37,0	6°	0,15	4,9	11,5	6	195904 NEW
	P2537	3,0	.118	37,0	6°	0,15	4,9	11,5	6	195905 NEW

PolyMILL

Slot Milling, Cross Toothed

- Insert holder see page 90-92
- Cutting data see page 166

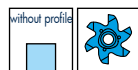
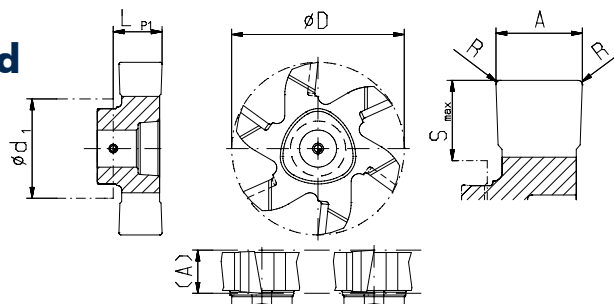

Type	A mm	A inch	D mm	Rake Angle	R mm	LP1 mm	Smax. mm	Number of teeth	Order No. TINAMATIC	
P16	P1616	5,0	.197	16,0	6°	0,15	5,65	3,5	6	171699
P20	P2020	5,0	.197	20,0	6°	0,15	5,65	4,2	6	171700
	P2022	4,0	.157	21,7	6°	0,15	5,0	5,0	6	163659
P25	P2022	5,0	.197	21,7	6°	0,15	6,0	5,0	6	187948
	P2526	5,0	.197	26,0	6°	0,15	6,9	6,2	6	171701
	P2526	6,5	.256	26,0	6°	0,15	7,15	6,2	6	171702
	P2528	4,0	.157	27,7	6°	0,15	5,9	6,8	6	177186
	P2528	5,0	.197	27,7	6°	0,15	5,9	6,8	6	177187
	P2537	1,0	.039	37,0	6°	0,15	4,9	11,5	6	195906 NEW
	P2537	1,5	.059	37,0	6°	0,15	4,9	11,5	6	195907 NEW
	P2537	2,0	.079	37,0	6°	0,15	4,9	11,5	6	195909 NEW
	P2537	2,5	.098	37,0	6°	0,15	4,9	11,5	6	195910 NEW
	P2537	3,0	.118	37,0	6°	0,15	4,9	11,5	6	195911 NEW
	P2538	1,5	.059	27,7	6°	0,1	4,9	6,8	6	201415 NEW
	P2538	2,0	.079	27,7	6°	0,1	4,9	6,8	6	201416 NEW
	P2538	2,39	.094	27,7	6°	0,15	4,9	6,8	6	201417 NEW
	P2538	2,5	.098	27,7	6°	0,15	4,9	6,8	6	201418 NEW
	P2538	3,0	.118	27,7	6°	0,15	4,9	6,8	6	201419 NEW
P2538	3,175	.125	27,7	6°	0,15	5,0	6,8	6	201420 NEW	

Circlip Grooves

- With chamfered edge
- Insert holder see page 90-92
- Cutting data see page 166

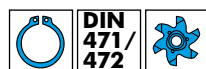
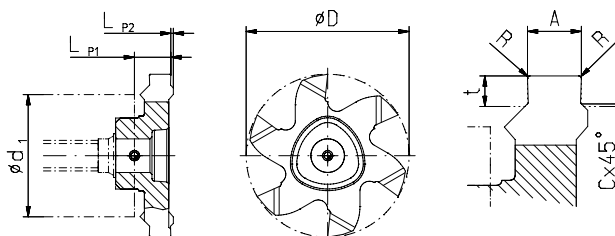

DIN 471/472

Type	DIN width H13	D mm	A _{0,03} mm	t mm	Cx45° mm	R mm	LP1 mm	LP2 mm	Number of teeth	Order No. TINAMATIC	
P16	P1616	1,10	16	1,18	0,50	0,10	0,05	3,15	0,675	6	142423
	P1616	1,30	16	1,38	0,85	0,15	0,05	3,15	0,675	6	142528
	P1616	1,60	16	1,68	1,00	0,15	0,1	3,15	0,675	6	142561
	P1616	1,85	16	1,93	1,25	0,20	0,1	3,15	0,675	6	142562
P20	P2020	1,10	20	1,18	0,50	0,10	0,05	3,15	0,675	6	168675
	P2020	1,30	20	1,38	0,85	0,15	0,05	3,15	0,675	6	168676
	P2020	1,60	20	1,68	1,00	0,15	0,1	3,15	0,675	6	168677
	P2020	1,85	20	1,93	1,25	0,20	0,1	3,15	0,675	6	168678
	P2022	1,60	21,7	1,68	0,85	0,15	0,1	4,7	0,45	6	171968
	P2022	1,85	21,7	1,93	1,25	0,20	0,1	4,7	0,45	6	171969
	P2022	2,15	21,7	2,23	1,50	0,20	0,1	4,7	0,45	6	171970
P25	P2022	2,65	21,7	2,73	1,50	0,20	0,2	4,8	0,35	6	171971
	P2526	1,30	26	1,38	0,85	0,15	0,05	3,4	0,425	6	142646
	P2526	1,60	26	1,68	1,00	0,15	0,1	3,4	0,425	6	142660
	P2526	1,85	26	1,93	1,25	0,20	0,1	3,4	0,425	6	142607
	P2526	2,15	26	2,23	1,50	0,20	0,1	3,4	0,425	6	142591
	P2526	2,65	26	2,73	1,75	0,20	0,2	4,25	0,575	6	142597
	P2526	3,15	26	3,23	1,75	0,20	0,2	4,25	0,575	6	142661
	P2526	4,15	26	4,23	2,00	0,20	0,2	6,415	0,560	6	142622
	P2526	4,15	26	4,23	2,50	0,20	0,2	6,415	0,560	6	160893

PolyMILL

Circlip Grooves

- Without chamfered edge
- Insert holder see page 90-92
- Cutting data see page 166

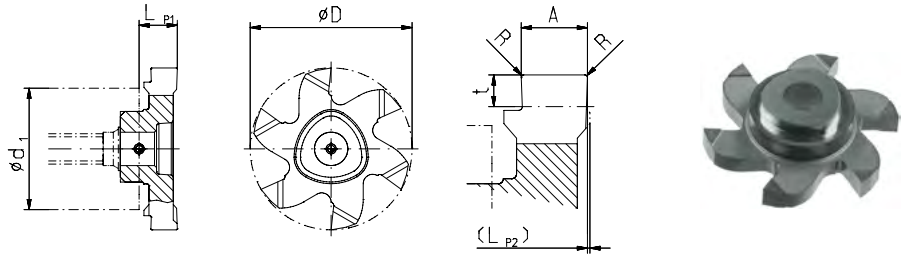

Type	DIN width H13	D mm	A _{0,03} mm	t mm	R mm	LP1 mm	LP2 mm	Number of teeth	Order No TINAMATIC	
P12	P1210 *	0,90	9,6	0,98	1,20	0,05	3,25	0,1	3	172125
	P1212	1,10	11,7	1,18	0,90	0,05	3,55	-	3	171868
	P1212	1,30	11,7	1,38	1,10	0,05	3,55	-	3	171869
	P1212	1,60	11,7	1,68	1,00	0,1	3,55	-	3	171870
P16	P1616	1,10	16,0	1,18	0,90	0,05	3,45	-	6	142548
	P1616	1,30	16,0	1,38	1,10	0,05	3,45	-	6	142509
	P1616	1,60	16,0	1,68	1,25	0,1	3,45	-	6	142533
	P1616	1,85	16,0	1,93	1,25	0,1	3,45	-	6	142536
	P1618	1,10	17,7	1,18	0,90	0,05	4,0	-	6	171945
	P1618	1,30	17,7	1,38	1,10	0,05	4,0	-	6	171946
	P1618	1,60	17,7	1,68	1,25	0,1	3,9	-	6	171947
	P1618	1,85	17,7	1,93	1,25	0,1	4,0	-	6	171948
P20	P2020	1,10	20,0	1,18	0,90	0,05	3,65	-	6	168679
	P2020	1,30	20,0	1,38	1,10	0,05	3,65	-	6	168680
	P2020	1,60	20,0	1,68	1,25	0,1	3,65	-	6	168681
	P2020	1,85	20,0	1,93	1,25	0,1	3,65	-	6	168682
	P2022	1,60	21,7	1,68	1,25	0,1	5,0	-	6	171964
	P2022	1,85	21,7	1,93	1,25	0,1	5,0	-	6	171965
	P2022	2,15	21,7	2,23	1,75	0,1	5,0	-	6	171966
	P2022	2,65	21,7	2,73	1,75	0,2	5,0	-	6	171967
P25	P2526	1,30	26,0	1,38	1,10	0,05	3,65	-	6	142598
	P2526	1,60	26,0	1,68	1,25	0,1	3,65	-	6	142653
	P2526	1,85	26,0	1,93	1,25	0,1	3,65	-	6	142616
	P2526	2,15	26,0	2,23	1,75	0,1	3,65	-	6	142637
	P2526	2,65	26,0	2,73	1,75	0,2	3,65	-	6	142662
	P2526	3,15	26,0	3,23	2,20	0,2	4,55	-	6	142643
	P2526	4,15	26,0	4,23	2,50	0,2	6,80	-	6	160906

* Not suited for cutter 177676

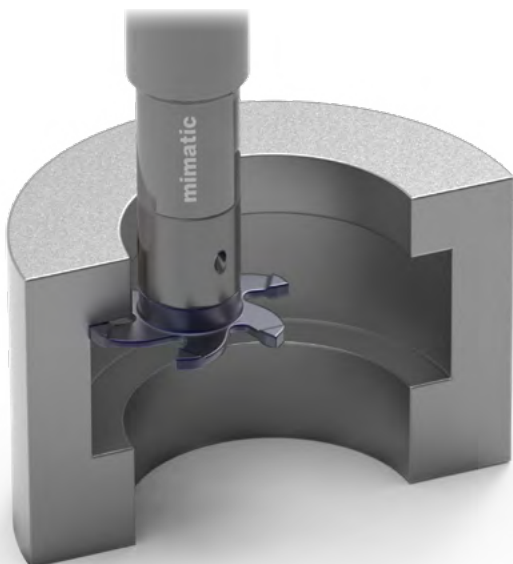

Circular Milling Tools with Polygonal Insert Seat

- Inserts see page 86-89
- Cutting data see page 166

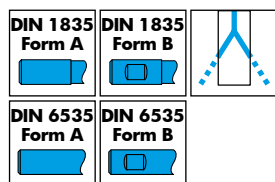
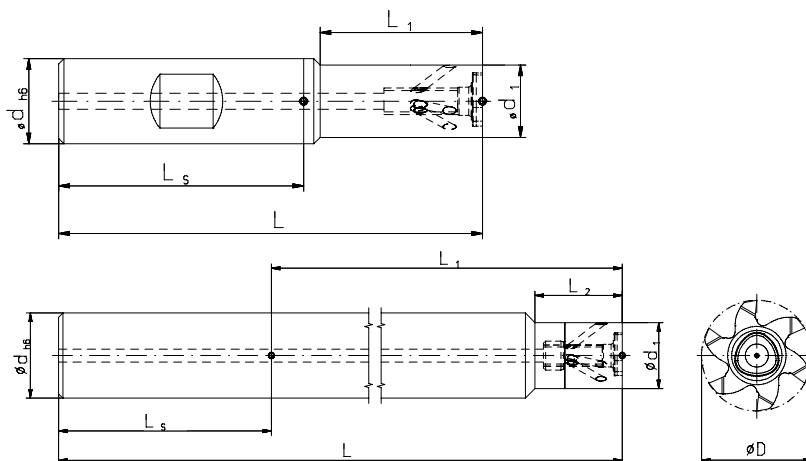

Type	Order No.	Form	d h6 mm	d1 mm	D max. mm	S max. (D-d1)/2 mm	L mm	L1 mm	L2 mm	Shaft	Spare part No.	
											Screw-driver*	Screw*
P12	177170	A	10	7,0	11,7	2,35	54	8	-	Steel	T8 IP 111656	M2,5x7 107596
	123619	B	12	7,0	11,7	2,35	67,5	20	-	Steel		
	100228	B	12	7,0	11,7	2,35	67,5	20	-	Carbide		
	171778	A	12	7,0	11,7	2,35	67,5	20	-	Carbide		
	171780	B	12	7,0	11,7	2,35	80	30	-	Carbide		
	171781	A	12	7,0	11,7	2,35	80	30	-	Carbide		
	171783	B	12	7,0	11,7	2,35	100	40	-	Carbide		
	171784	A	12	7,0	11,7	2,35	100	40	-	Carbide		
P16	177174	A	10	9,0	17,7	4,35	60	11	-	Steel	T8 IP 111656	M3x12 143158
	123573	B	12	9,0	17,7	4,35	67,4	21	-	Steel		
	123577	B	12	9,0	17,7	4,35	67,4	21	-	Carbide		
	171787	A	12	9,0	17,7	4,35	67,4	21	-	Carbide		
	123580	B	12	9,0	17,7	4,35	82,4	36	-	Carbide		
	171789	A	12	9,0	17,7	4,35	82,4	36	-	Carbide		
	123584	A	12	9,0	17,7	4,35	100	30	-	Carbide		
	123588	A	12	11,5	17,7	2,85	82,4	37,4	13	Carbide		
123590	A	12	12,0	17,7	2,85	122,5	77,5	-	Carbide			
P20	177178	A	12	11,5	21,7	5,1	62,4	14,4	-	Steel	T15 IP 111671	M4x13 107597
	123615	B	16	11,5	21,7	5,1	80	30	-	Steel		
	123616	B	16	11,5	21,7	5,1	80	30	-	Carbide		
	171794	A	16	11,5	21,7	5,1	80	30	-	Carbide		
	123617	B	16	11,5	21,7	5,1	100	50	-	Carbide		
	171796	A	16	11,5	21,7	5,1	100	50	-	Carbide		
	174314	A	16	15,5	21,7	3,1	105,5	57,5	20	Carbide		
P25	177182	A	16	13,6	27,7	7,05	69,6	20,4	-	Steel	T20 IP 111594	M5x13,5 107529
	123592	B	16	13,6	27,7	7,05	79,6	30,5	-	Steel		
	123598	B	16	13,6	27,7	7,05	79,6	30,5	-	Carbide		
	171855	A	16	13,6	27,7	7,05	79,6	30,5	-	Carbide		
	123600	B	16	13,6	27,7	7,05	94,6	45,5	-	Carbide		
	171857	A	16	13,6	27,7	7,05	94,6	45,5	-	Carbide		
	123603	B	16	13,6	27,7	7,05	109,6	60,5	-	Carbide		
	171859	A	16	13,6	27,7	7,05	109,6	60,5	-	Carbide		
	123609	A	16	15,5	27,7	6,1	105	57	21,5	Carbide		
	123611	A	16	15,5	27,7	6,1	149,5	101,5	21,5	Carbide		
	161205	NEW	A	20	15,5	27,7	6,1	100	52	21,5		
123613	A	20	15,5	27,7	6,1	174,45	128,5	21,5	Carbide			

Screw torques max.

107596	T08 IP	1,0 Nm
143158	T08 IP	1,1 Nm
107597	T15 IP	3,8 Nm
107529	T20 IP	5,5 Nm

* Screwdriver and clamping screw included in delivery

Circular Milling Tools for Driven Toolholders

- Inserts see page 86-89
- Cutting data see page 166

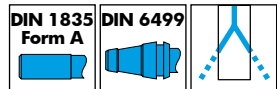
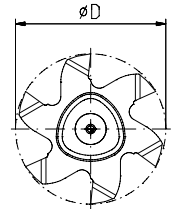
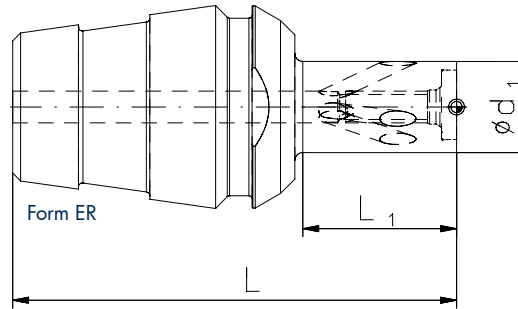
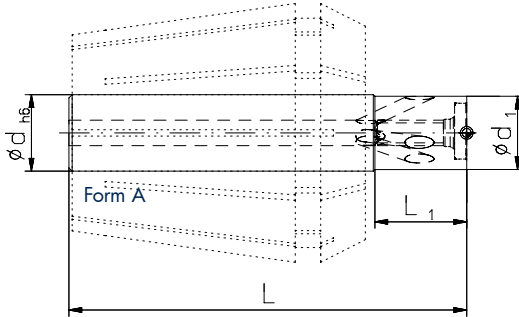

5

Type	Order No.	Form	d _{h6} mm	d ₁ mm	D _{max.} mm	S _{max.} (D-d ₁)/2 mm	L mm	L ₁ mm	Shaft	Spare part No.	
										Screw-driver *	Screw *
P12	177170	A	10	7,0	11,7	2,35	54	8	Steel	T8 IP 111656	M2,5x7 107596
	177172	ER 16		7,0	11,7	2,35	37,5	8	Steel		
	177173	ER 20		7,0	11,7	2,35	47	13	Steel		
P16	177174	A	10	9,0	17,7	4,35	60	11	Steel	T8 IP 111656	M3x12 143158
	177176	ER 16		9,0	17,7	4,35	41,4	11	Steel		
	177177	ER 20		9,0	17,7	4,35	51	16	Steel		
P20	177178	A	12	11,5	21,7	5,1	62,4	14,4	Steel	T15 IP 111671	M4x13 107597
	177180	ER 20		11,5	21,7	5,1	49,5	14,5	Steel		
	177181	ER 25		11,5	21,7	5,1	56	19,4	Steel		
P25	177182	A	16	13,6	27,7	7,05	69,6	20,4	Steel	T20 IP 111594	M5x13,5 107529
	177184	ER 25		13,6	27,7	7,05	56	19,4	Steel		
	177185	ER 32		13,6	27,7	7,05	73	30,4	Steel		

Screw torques max.

107596	T8 IP	1,0 Nm
143158	T8 IP	1,1 Nm
107597	T15 IP	3,8 Nm
107529	T20 IP	5,5 Nm

Changing Inserts

Clamp cutter before changing insert. Loosen insert screw. Remove used insert and clean the insert pocket before clamping new insert. Please use the appropriate TIP hex key for the tightening of the inserts and consider the screw tightening torques in the tables.

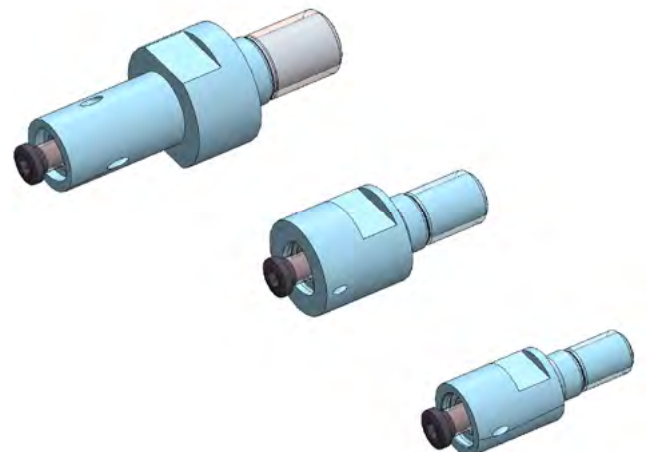

* Screwdriver and clamping screw included in delivery

PolyMILL

Circular Milling Tools with Polygonal Insert Seat

- Inserts see page 86-89
- Cutting data see page 166

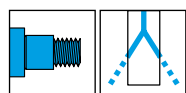
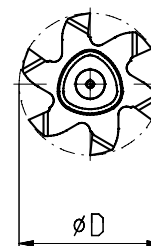
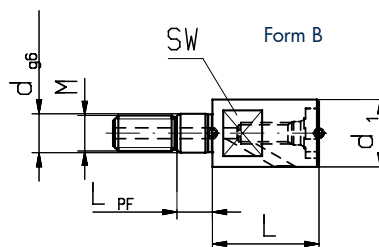
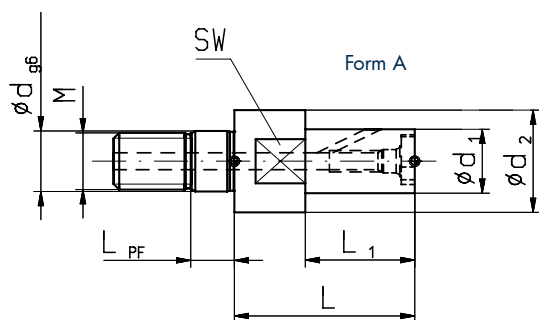

Please adapt cutting data to overhangs length

Type	Order No.	Form	d1 mm	d2 mm	D _{max.} mm	S _{max.} (D-d1)/2 mm	L mm	L1 mm	M	dg6 mm	L _{PF} mm	Spare part No.	
												Screw-driver *	Screw *
P12***	177676	B	9,5	-	11,7	1,1	13,5	-	M5	5,5	5,0	111656	107596
P16	123586	A	9,0	14,4	17,7	4,35	29,5	19,5	M8	8,5	5,5	111656	143158
P16**	177683	B	9,5	-	17,7	4,1	18,5	-	M5	5,5	5,0	111656	143158
P16***	177698	B	11,0	-	17,7	3,35	18,5	-	M6	6,5	5,0	111656	143158
P20	123618	A	11,5	18,0	21,7	5,1	35,0	25,0	M10	10,5	5,5	111671	107597
P20**	177734	B	11,5	-	21,7	5,1	20,5	-	M6	6,5	5,0	111671	107597
P20***	177735	B	13,5	-	21,7	4,1	20,5	-	M8	8,5	5,5	111671	107597
P25	123605	A	13,6	22,5	27,7	7,05	42,5	29,5	M12	12,5	5,5	111594	107529
P25**	177747	B	13,6	-	27,7	7,05	22,6	-	M8	8,5	5,5	111594	107529
P25***	177767	B	18,0	-	27,7	4,85	22,6	-	M10	10,5	5,5	111594	107529

- * Screwdriver and clamping screw included in delivery
- ** Slim design for thread milling
- *** Reinforced design

Screw torques max.		
107596	T8 IP	1,0 Nm
143158	T8 IP	1,1 Nm
107597	T15 IP	3,8 Nm
107529	T20 IP	5,5 Nm

Assembling Instructions

- Recommended tightening torque for screw-in circular milling body
- End-wrench see page 151

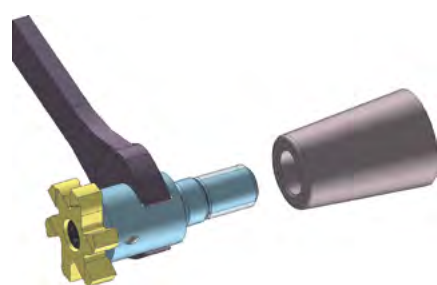

Thread size (M)	Wrench size mm	Tightening torque Nm
M5	7	8
M6	9	10
M8	11	25
M10	15	40
M12	19	60
M16	24	80

mimatic®

Tool Systems

Your Partner For Clever Tooling

- Circular- and Thread Milling Tools
- RPK-Reamers with Polygonal Interface
- Driven Toolholders for CNC Machining Centers
- Driven Toolholders for CNC Turning Machines
- Multi-Spindle Technology
- Modular Quick Change Toolholders mimatic® mi
- Static Toolholders for CNC Turning Machines
- Precision Chucks
- Special Cutting Tools



203238 KATALOG-ZW-E09



mimatic®
Tool Systems



mimatic GmbH
Westendstraße 3
D-87488 Betzigau
Tel. +49 (0) 831 / 574 44-0
info@mimatic.de
www.mimatic.de